

# State of Wyoming Corner Record

(In compliance with the CORNER PERPETUATION AND FILING ACT, Wyoming Statutes, 1997 Section 33-29-140 et. seq., and the Rules and Regulations of the Board of Professional Engineers and Professional Land Surveyors)

*Reverse side of this form may be used if more space is needed.*

Record of original survey and citation of source of historical information (if corner is lost or obliterated). Description of corner monumentation evidence found and/or monument and accessories established to perpetuate the location of this corner. Sketch of relative location of monument, accessories, and reference points with course and distance to adjacent corner(s) (if determined in this survey). Method and rationale for reestablishment of lost or obliterated corner.

**RECORD:** GLO RECORD UNKNOWN.

**MONUMENT FOUND:** FOUND A 8" X 6" GRANITE STONE PROJECTING 7" ABOVE GROUND SURFACE WITH 1 NOTCH TO THE SOUTH AND 5 NOTCHES ON THE EAST SIDE.

**MONUMENT SET:** NOTHING SET. SURROUNDED STONE WITH A RING OF STONES.

**REFERENCES:** MONUMENT LIES ON A SOUTH FACING SLOPE +/- 75' FROM THE TOP OF A RIDGE RUNNING E-W. NO NEARBY OBJECTS TO REFERENCE TO.

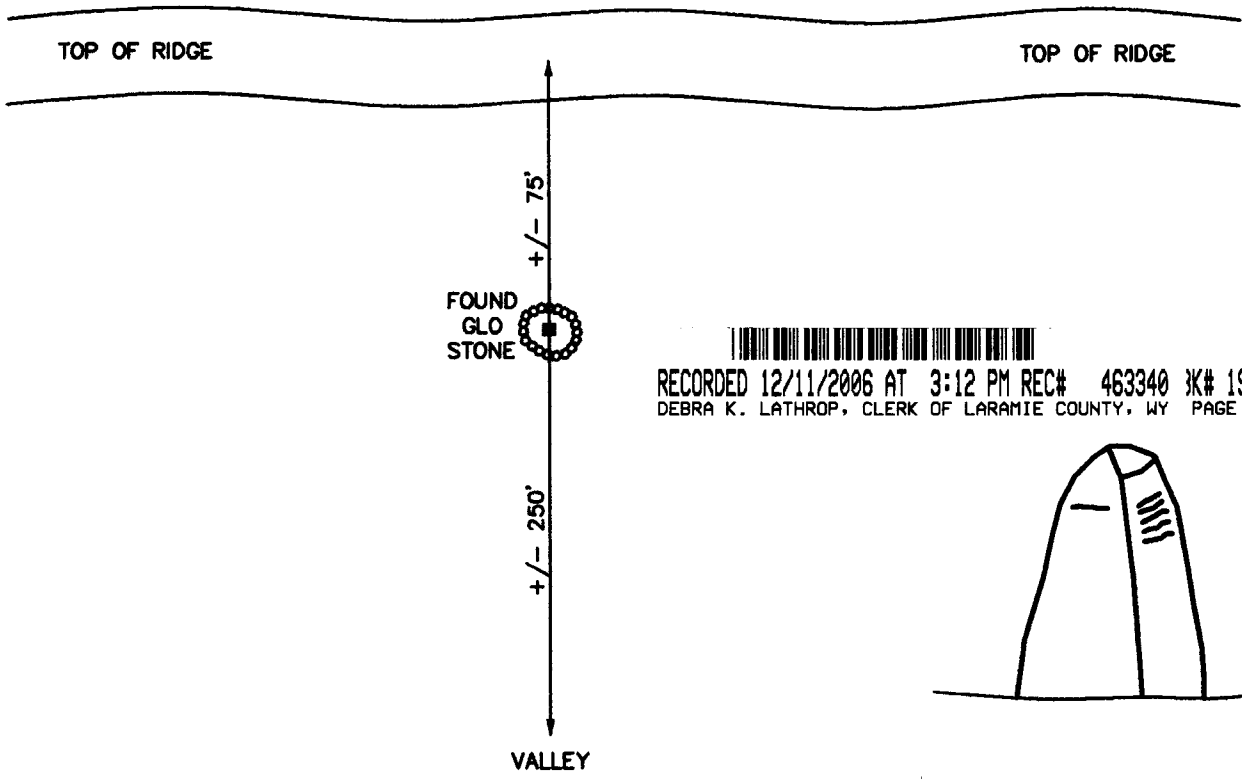

  
 RECORDED 12/11/2006 AT 3:12 PM REC# 463340 3K# 1982 PG# 1802  
 DEBRA K. LATHROP, CLERK OF LARAMIE COUNTY, WY PAGE 1 OF 2

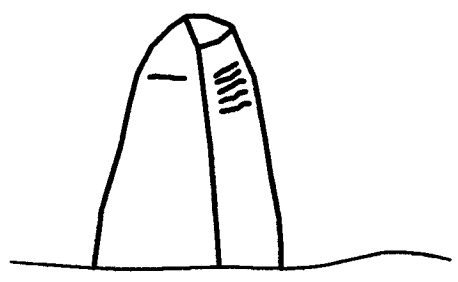

Date of Field Work: 9-10-99

Office Reference: 99209

## Monument Inscription

**Cross Index Plat**

	1	2	3	4	5	6	7	8	9	10	11	12	13	14	15	16	17	18	19	20	21	22	23	24	25			
A																											B	
B																												C
C			6		5			4				3				2				1								D
D																												E
E																												F
F																												G
G																												H
H																												I
I																												J
J																												K
K																												L
L																												M
M																												N
N																												O
O																												P
P																												Q
Q																												R
R																												S
S																												T
T																												U
U																												V
V																												W
W																												X
X																												Y
Y																												Z
	1	2	3	4	5	6	7	8	9	10	11	12	13	14	15	16	17	18	19	20	21	22	23	24	25			

Firm/Agency, Address

**STEEL SURVEYING SERVICES LLC**  
**1102 WEST 19th STREET**  
**CHEYENNE WY 82001**

Telephone Number: **(307) 634-7273**

*This corner record was prepared by me or under my direction and supervision.*

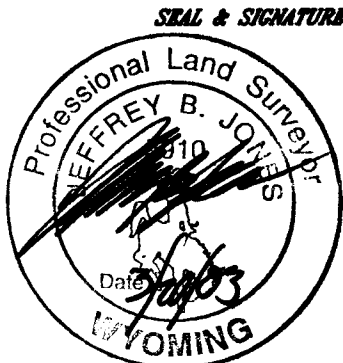

Corner Name SE CORNER Section 30, T 18 N, R 67 W, 6th P.M. Cross-Index No.: V-5  
 County: LARAMIE Wyoming  
 SBRPEPLS/PLSW: March 1994; PLSW January 1998

